

**INSTRUCTIONS FOR INSTALLING A WATER LEVEL SWITCH ACTUATOR REPLACEMENT
KIT IN A NATIONAL VENDORS[®], CROWN SEVENTY TWO[®] CDM-72A OR CDM-312
COLD DRINK MERCHANDISER**

**CHECK THE PARTS RECEIVED IN THE KIT WITH THE PARTS LIST
IN THESE INSTRUCTIONS. IF ANY PARTS ARE MISSING, CONTACT
NATIONAL VENDORS' PARTS DEPARTMENT IMMEDIATELY.**

These instructions cover the procedure for installing a Water Level Switch Actuator Replacement Kit in a Crown Seventy Two CDM-72A or CDM-312 Cold Drink Merchandiser.

Read these instructions carefully and thoroughly before installing the kit. Retain these instructions for part number and installation information.

Kit, Water Level Switch Replacement, part number 311-8051, contains the following parts:

Part Number	Description	Quantity
311-8007	Low Water Level Switch Actuator	1
311-8008	Water Level Switch Actuator	1
610-4194	Dodge Expansion Insert	1
312-8169	No.4-40 x -.250 RHS T/C Screw	1
613-8080	No.4 Split-Type Lockwasher	1
311-8116	Installation Instructions	1

TO INSTALL THE KIT

A. PARTS REMOVAL

1. Unlock and open the Cabinet Door.
2. Move the Main Switch to the OFF position.
3. Disconnect the Inlet Valve-to-Feeder Cup Tube from the Water Feeder Assembly. See Figure 1.
4. Lift the Switch Cover off the Water Feeder Assembly. See Figure 1.

NOTE

When performing Step A-5, mark the Switch Receptacles to insure that the Receptacles are correctly matched to the Switches when reinstalling the Water Feeder Cover.

5. Disconnect the Switch Receptacles of the Feeder Cup Harness from the Inlet and Low Water Level Switches of the Water Feeder Assembly. See Figure 1.

6. Lift the Water Feeder Cover off the Water Feeder Cup and remove from the Merchandiser.
7. Screw the Float Shaft out of the insert in the bottom of the Water Level Switch Actuator. Leave the Nut w/Lockwasher in place on the Float Shaft. See Figure 1.
8. Remove the defective Water Level Switch Actuator from the Water Feeder Cover as follows:
 - a. Pull the Low Water Level Switch Actuator out of the long channel in the Water Level Switch Actuator. Be sure to retain the Low Water Level Switch Actuator. See Figure 1.
 - b. Remove the Drive Screw from the Water Level Switch Actuator. See Figure 1.
 - c. Pull the Water Level Switch Actuator through the opening in the bottom of the Water Feeder Cover.

B. INSTALLATION OF THE KIT

1. Install the Dodge Expansion Insert, part number 610-4194, in the bottom of the replacement Water Level Switch Actuator, part number 311-8008, pushing the Expansion Insert into the Actuator until the open end of the Expansion Insert is flush with the bottom of the Actuator. Both parts are included in the kit. See Figure 2.
2. Insert the replacement Water Level Switch Actuator through the opening in the bottom of the Water Feeder Cover. See Figure 2.
3. With the Water Level Switch Actuator inserted as far as it will go into the Water Feeder Cover, install the Screw, part number 312-8169, and the Lockwasher, part number 613-8080, in the hole in the Water Level Switch Actuator. See Figure 2.
4. Place the Low Water Level Switch Actuator in the long channel of the Water Level Switch Actuator. Position the Low Water Level Switch Actuator as shown in Figure 2 and insert from the top of the channel.

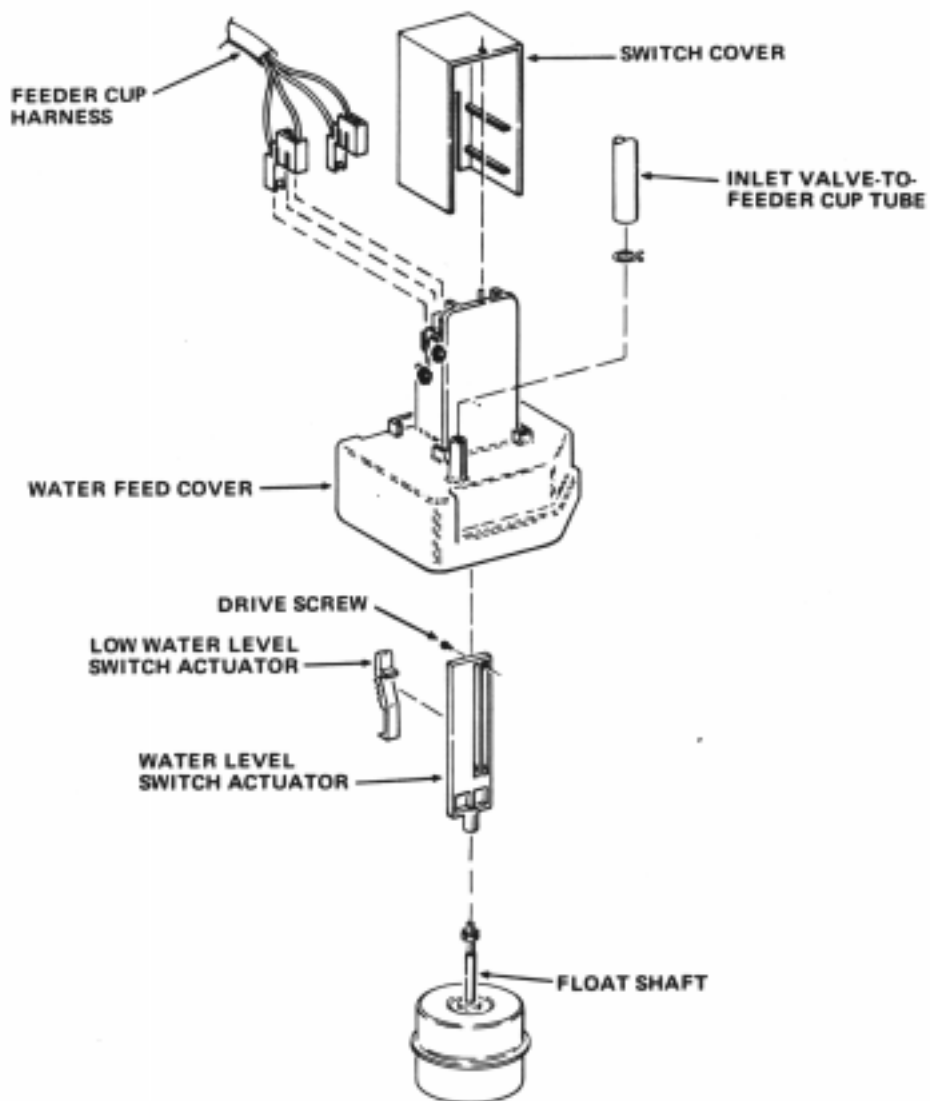

FIGURE 1

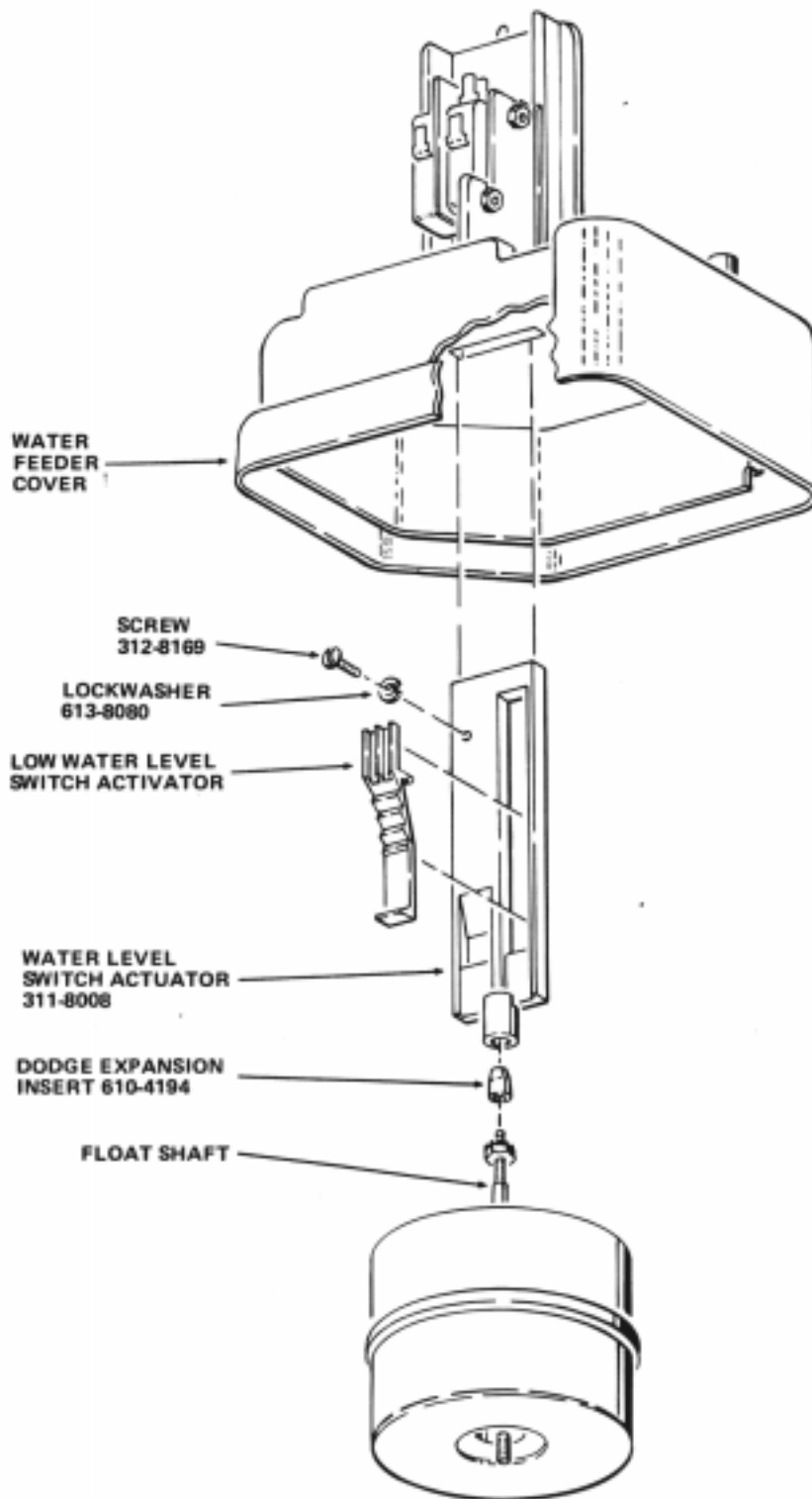

FIGURE 2

5. Connect the Float Assembly to the Water Level Switch Actuator as follows:
 - a. Screw the Float Shaft as far as it will go into the Dodge Expansion Insert installed in Step B-1. See Figure 2.
 - b. Lock the Float Shaft in place with the Nut w/Lockwasher.
6. Place the Water Feeder Cover on the Water Feeder Cup.
7. Connect the Switch Receptacles of the Feeder Cup Harness to the Inlet and Low Water Level Switches. See Figure 1.
8. Install the Switch Cover on the Water Feeder Assembly. See Figure 1.
9. Connect the Inlet Valve-to-Feeder Cup Tube to the Water Feeder Assembly. See Figure 1.
10. Move the Main Switch to the ON position.
11. Test Vend Merchandiser to check for proper operation.
12. Close and lock the Cabinet Door.